



THE CITY OF NEW YORK
 MANHATTAN COMMUNITY BOARD 3
 59 East 4th Street - New York, NY 10003
 Phone (212) 533-5300
 www.cb3manhattan.org - info@cb3manhattan.org

Jamie Rogers, Board Chair

Susan Stetzer, District Manager

Community Board 3 Liquor License Application Questionnaire

Today's Date: _____

APPLICANT

1. Name of applicant and principle(s): _____
2. Premise address: _____
3. Cross streets: _____
4. Trade name (DBA): _____
5. Check which you are applying to: New liquor licence Alteration of an existing license Sale of assets
6. If alteration, describe nature of alteration: _____
7. Is location currently licensed? Yes No
8. Type of license: _____
9. Previous or current use of the location: _____
10. Corporation and trade name of current location: _____
11. Type of building and number of floors: _____
12. Does premise have a valid Certificate of Occupancy and all appropriate permits, including for any back or side yard use? Yes No 12a. What is the permitted occupancy indoors and outdoors? _____
13. Do you plan to apply for Public Assembly permit? Yes No
14. What is the zoning designation (check zoning using map: <http://gis.nyc.gov/doitt/nycitymap/> - please give specific zoning designation, such as R8 or C2): _____
15. How many licensed establishments are within 1 block? _____
16. How many On-Premise (OP) liquor licenses are within 500 feet? _____
17. Is premise within 200 feet of any school or place of worship? Yes No

PROPOSED METHOD OF OPERATION

18. Describe your method of operation: _____
19. Will any other business besides food or alcohol service be conducted at premise? Yes No
20. If yes, please describe what type: _____
21. What are the proposed days/hours of operation (specify days/hours each day and hours of outdoor space if applicable):

22. Total number of table: _____ 23. Total number of seats: _____



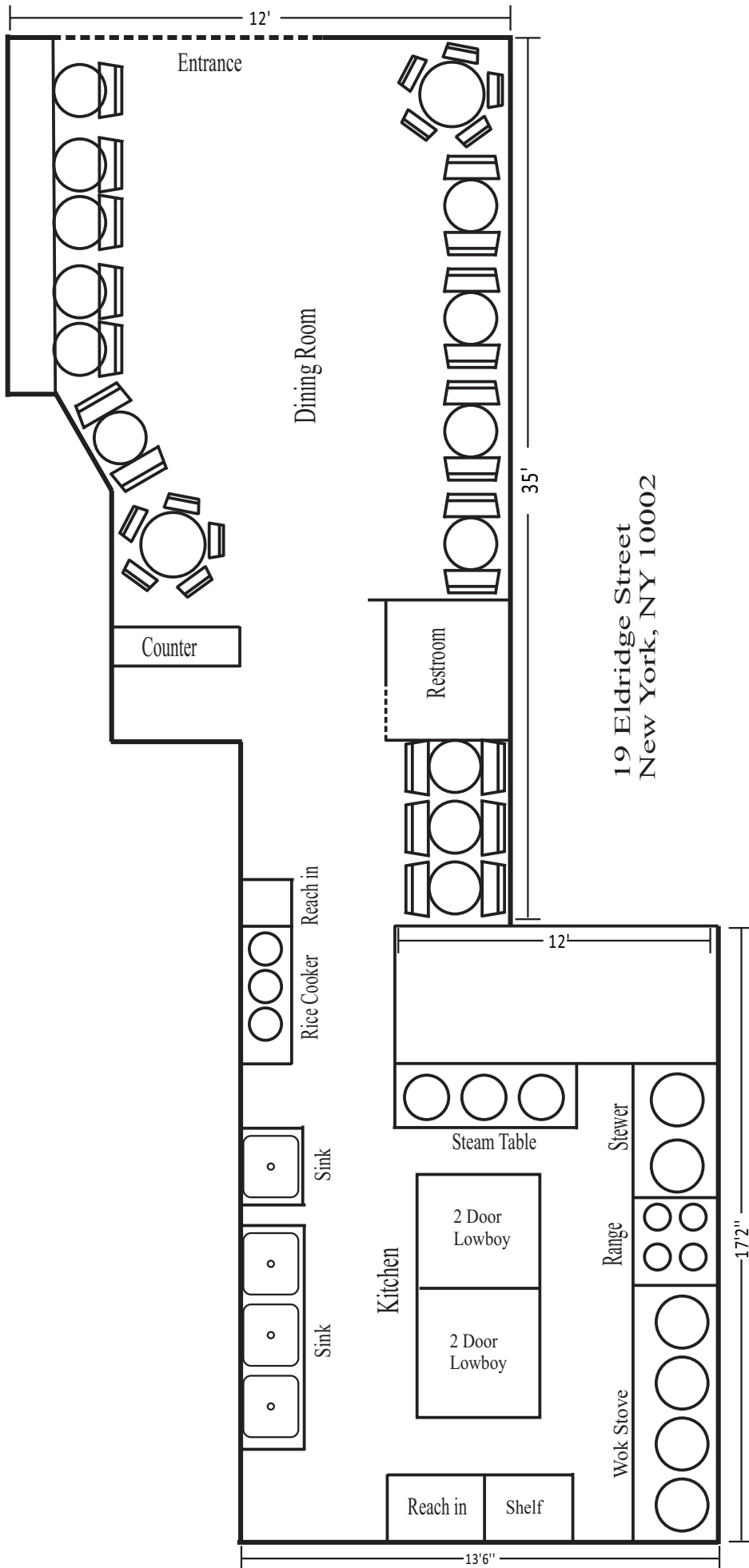

Entrance

12'

Dining Room

Counter

Restroom

35'

19 Eldridge Street
New York, NY 10002

Rice Cooker
Reach in

12'

Steam Table

Kitchen

2 Door
Lowboy

2 Door
Lowboy

Sink

Sink

Range
Stewer

Wok Stove

Reach in

Shelf

13'6"

17'2"

頭 臺 APPETIZERS

- | | | |
|-------------------|-----------------------|----------------|
| 1. 自制蘿卜幹 | Homemade Dried Turnip | \$3 |
| 2. 五香花生 | Peanut | \$3 |
| 3. 海帶絲 | Seaweed | \$3 |
| 4. 毛豆 | Edamame | \$3 |
| 5. 滷豬耳朵 | Stewed Pork Ear | \$3 |
| 6. 滷牛肉 | Stewed Beef | \$3 |
| 7. 滷老鷄翅 | Stewed Chicken Wing | \$3 |
| 8. 滷鴨翅 | Duck Wing | \$3 |
| 9. 小籠包 | Juicy Pork Dum | \$3 |
| 10. 兩拼 | Two Choices | \$4 |
| 11. 三拼 | Three Choices | \$5 |

飯 RICE

- | | | |
|---------|-----------------------------------|------|
| 12. 牛腩飯 | Stewed Beef Brisket & Tendon Rice | \$8 |
| 13. 排骨飯 | Sparerib Rice | \$7 |
| 14. 鴨胸飯 | Duck Breast Rice | \$12 |
| 15. 鴨腿飯 | Duck Leg Rice | \$8 |
| 16. 鷄扒飯 | Grilled Chicken Rice | \$7 |
| 17. 鰻魚飯 | Eel Rice | \$12 |
| 18. 羊扒飯 | Grilled Lamb Rice | \$15 |

面 NOODLE

- | | | |
|---------------------|------------------------------|----------------|
| 19. 肚片花生米粉 | Pig Tail & Peanut Noodle | \$7 |
| 20. 番鴨粉幹 | Duck Noodle | \$7 |
| 21. 老鷄粉幹 | Chicken Noodle | \$6 |
| 22. 上排綫面 | Spareribs Noodle | \$7 |
| 23. 烏鷄米燕 | Black Chicken Noodle | \$7 |
| 24. 牛尾粉幹 | Beef Tail Noodle | \$7 |
| 25. 水鴨面 | Duck Noodle | \$7 |
| 26. 鴨翅粉幹 | Duck Wings Noodle | \$6 |
| 27. 鷄扒面 | Grilled Chicken Noodle | \$7 |

炖 盅 STEW SOUP

- | | | |
|----------|-------------------------|-----|
| 28. 肚片花生 | Pig Tail & Peanut Soup | \$7 |
| 29. 番鴨 | Duck Soup | \$7 |
| 30. 老鷄 | Chicken Soup | \$6 |
| 31. 上排 | Spareribs Soup | \$7 |
| 32. 烏鷄 | Black-bone Chicken Soup | \$7 |
| 33. 牛尾 | Beef Tail | \$7 |
| 34. 水鴨 | Duck | \$7 |



梅洋站

My Noodle Station

929-320-0555

19B Eldridge St.
New York, NY 10002

(19B 愛烈治街)

MONDAY - SUNDAY 11 AM - 10 PM

~~THU~~ - CLOSED

(周四休息)



Like us on Facebook

MY NoodleStation

www.Mynoodlestation.com



面類: 米粉, 綫面, 米綫, 公仔面,
烏冬, 日本拉麵, 瀨粉

**Noodle: Mai Fun, Thread Noodle,
Rice Noodle, Instant Noodle, Udon,
Japanese Ramen**

- | | | | |
|-----|-----------|---|------|
| B1. | 火 車 頭 | Vietnamese Noodle Soup | \$9 |
| B2. | 牛 肉 面 | Beef Noodle Soup | \$8 |
| B3. | 牛 腩 面 | Stewed Beef Brisket
& Tendon Noodle | \$8 |
| B5. | 紅燒牛肉烏冬 | 🔥 Braised Beef with Udon | \$10 |
| P1. | 排 骨 面 | Sparerib Noodle | \$7 |
| P3. | 上 湯 水 餃 | Dumplings with Soup | \$5 |
| P4. | 水 餃 | Steam Dumpling | \$3 |
| D1. | 鴨 胸 面 | Duck Breast Noodle Soup | \$12 |
| D2. | 鴨 腿 面 | Duck Leg Noodle Soup | \$8 |
| L1. | 羊 扒 面 | Grilled Lamb Noodle | \$15 |
| L2. | 醬 燴 面 | 🔥 Fried Bean Sauce Noodles
<i>Chicken/Beef/Duck Breast</i> | \$8 |
| L3. | 醬 燴 飯 | 🔥 Fried Bean Sauce Rice
<i>Chicken/Beef/Duck Breast</i> | \$8 |
| L4. | 菜醬燴面/飯 | 🔥 Veg Sauce w/ Rice or Noodle | \$6 |
| L5. | 雜 醬 面 | 🔥 Fried Bean Sauce Noodles | \$7 |
| S1. | 鮑 魚 面 | Abalone Noodle Soup | \$25 |
| S2. | 龍 蝦 面 | Lobster Noodle Soup | \$22 |
| S3. | 燒 鰻 魚 面 | Grill Eel Noodle Soup | \$12 |
| S4. | 真 蟹 肉 面 | Crab Meat Noodle Soup | \$12 |
| S5. | 海 鮮 大 會 | Seafood Delight
Noodle Soup Sm \$10 Lg \$15 | |
| S6. | 大 蝦 面 | Jumbo Shrimp Noodle Soup | \$10 |
| H1. | 梅 洋 站 湯 面 | House Special Noodle Soup | \$15 |
| M1. | 大 魚 丸 湯 | Big Fish Ball (5) | \$6 |
| M2. | 魚 丸 燕 湯 | Fish Ball
and Yan Wan Meat Ball | \$5 |
| M4. | 麥兜魚丸粗面 | Fish Ball Noodle | \$10 |

If you have a food allergy, please notify your server..

B5.

Braised Beef with Udon
特製紅燒牛肉烏冬麵



B1.

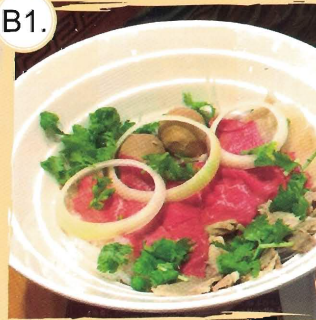

L1.



L2

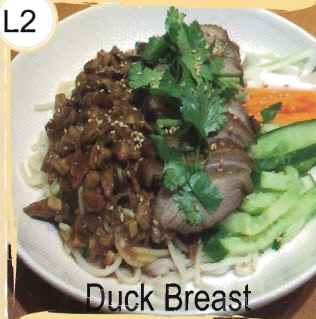

L3



L5

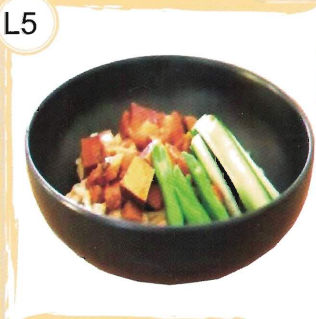

S1.



S6.



M4





THE CITY OF NEW YORK
 MANHATTAN COMMUNITY BOARD 3
 59 East 4th Street - New York, NY 10003
 Phone (212) 533-5300
 www.cb3manhattan.org - info@cb3manhattan.org

Jamie Rogers, Board Chair

Susan Stetzer, District Manager

Community Board 3 Liquor License Stipulations for Administrative Approval

I, Xiu Jie Yu, as a qualified representative of My Noodle Station Inc.
 located at 19 Eldridge Street, New York, NY agree to the following stipulations:

1. I will operate a full-service restaurant, specifically a (type of restaurant) Asian Food Restaurant
 Kitchen open and serving food every night during all hours of operation.
2. My hours of operation will be:
 Mon 11:00am ~ 12 am; Tue 11:00am ~ 12 am; Wed 11:00am ~ 12 am;
 Thu 11:00am ~ 12 am; Fri 11:00 am - 12 am; Sat 11:00am - 12 am; Sun 11:00am ~ 12 am.
 (I understand opening is no later than specified opening hour & all patrons are to be cleared from business at specified closing hour)
3. I will not use outdoor space for commercial use.
4. I will operate my sidewalk café no later than _____
5. I will employ a doorman/security personnel on the following days: _____
6. I will install soundproofing, _____
7. I will close any front or rear façade doors and windows at 10:00 P.M. every night or when amplified sound is playing, including but not limited to DJs, live music and live nonmusical performances. I will have a closed fixed façade with no open doors or windows except my entrance door will close by 10:00 P.M. or when amplified sound is playing, including but not limited to DJs, live music and live nonmusical performances.
8. I will not have DJs, live music, promoted events, any event at which a cover fee is charged, scheduled performances, more than _____ DJs/ promoted events per _____, more than _____ private parties per _____
9. I will play ambient recorded background music only.
10. I will not apply for an alteration to the method of operation or for any physical alterations of any nature without first coming before CB 3.
11. I will not seek a change in class to a full on-premise liquor license without first obtaining approval from CB 3.
12. I will not participate in pub crawls or have party buses come to my establishment.
13. I will not have unlimited drink specials, including boozy brunches, with food.
14. I will not have a happy hour or drink specials with or without time limitations OR I will have happy hour and it will end by _____.
15. I will not have wait lines outside. I will have a staff person responsible for ensuring no loitering, noise or crowds outside.
16. I will conspicuously post this stipulation form beside my liquor license inside of my business.
17. Residents may contact the manager/owner at the number below. Any complaints will be addressed immediately. I will revisit the above-stated method of operation if necessary in order to minimize my establishment's impact on my neighbors.

Name: Xiu Jie Yu Phone Number: 917-873-9996
 18. I will: _____

I hereby certify that the information provided above is truthful and accurate based upon my personal belief.
 Signed Xiu Jie Yu Dated 9/21/2017
 Sworn to this 21th day of September 2017
 Notary Public
HENRY X. ZHENG
 Notary Public, State of New York
 No. 01ZH5063559
 Qualified in New York County
 Commission Expires Dec. 15, 2017